

STEEL ANGLE ATTACHED to SUPERIOR WALLS®

The procedure as illustrated in the drawing below may be used to create a brick ledge on the face of a Superior Walls® panel. This procedure may also be used to support the edge of a concrete slab (porch or patio application).

CAUTION: Bolt and steel angle requirements must be followed carefully. Each job should be individually reviewed by a person competent in applying the structural design principles involved.

NOTE:

- Maximum load on steel brick ledge is 1000 lbs/lf
- Use hot dipped galvanized or stainless steel bolts, washers and nuts
- Seal wall penetrations with a polyurethane sealant
- Each job should be individually reviewed by a person competent in applying the structural design principles involved. In many jurisdictions this will require a registered design professional.

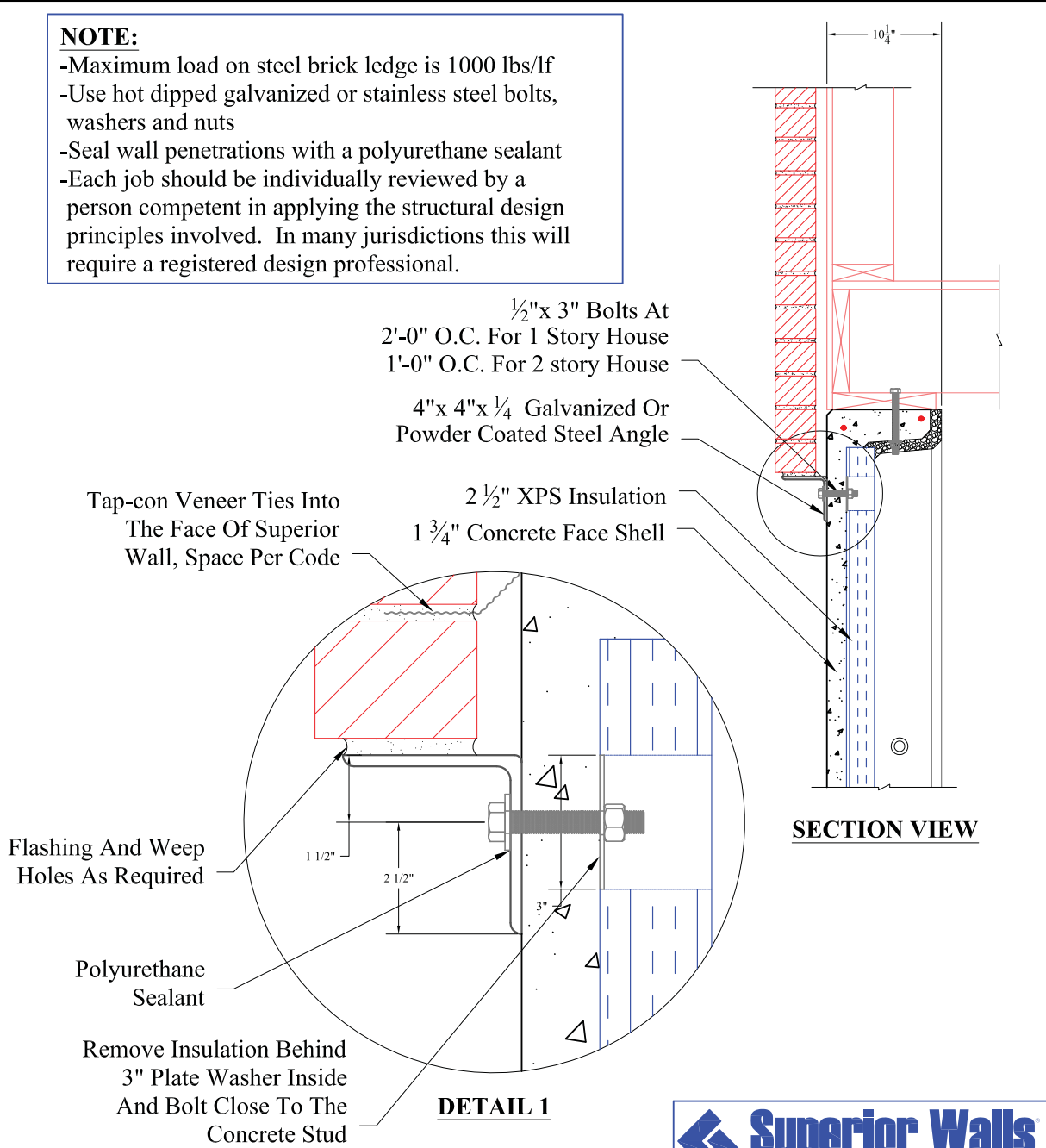

Superior Walls
www.superiorwalls.com
 937 East Earl Road, New Holland, PA 17557
 Phone: 800-452-9255 / Fax: 717-351-9263

NAME		DATE	PRODUCT LINE: Xi	
DRAWING BY:	NJEI	05/05/08	DESCRIPTION: Steel Angle Attached To A Superior Walls Panel	
COMMENTS: Rev: 05/28/10 Altered Notes			SIZE A	DWG NO / PART NO: 08-1010
			DRAWING SCALE: To Fit	REVISION 1
			PLOT SCALE: To Fit	SHEET: 1 of 1

©2008 Superior Walls of America, Ltd.